

**GATEWAY CHURCH, MORECAMBE  
STATEMENT OF ACCOUNTS  
FOR THE YEAR ENDED 31 DECEMBER 2020  
Charity Registration Number 1154420**

**Waters & Atkinson  
The Old Court House  
Clark Street  
MORECAMBE  
LA4 5HR**

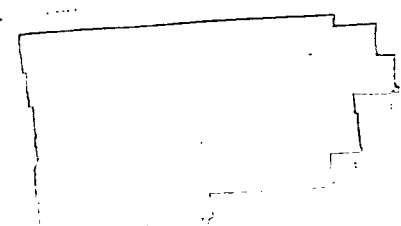

**CHARITY COMMISSION  
FIRST CONTACT  
- 6 JUL 2021  
ACCOUNTS  
RECEIVED**

RECEIVED  
ACCOUNTS  
AUG 11 1953  
FIRST CONTACT  
CHARITY COMMISSION

GATEWAY CHURCH, MORECAMBE  
YEAR ENDED 31 DECEMBER 2020

**Contents**

- 2 - 4 Trustees' Report**
- 5 Receipts and Payments Account**
- 6 Statement of Assets and Liabilities**
- 7 Independent Examiner's Report**

**GATEWAY CHURCH, MORECAMBE  
REPORT OF THE TRUSTEES**

The Trustees present their annual report for the year ended 31 December 2020.

**1. Legal and Administrative Information**

The Charity is known as Gateway Church, Morecambe, formerly Morecambe Bay Christian Fellowship, and is affiliated to Partners in Harvest. It is a registered charity, with the registered number of 1154420.

The Charity is governed by a constitution dated 2 June 2013 and its objectives are to enhance the christian faith, the relief of sickness, poverty and distress by any means the charity can provide, to educate, promote and preserve good health and well being to mankind.

The Trustees have asked Mr Damien Sissons of Waters & Atkinson Chartered Accountants to act as the Independent Examiner under the Charities Act 2011.

**2. Trustees**

The Trustees in office at the end of the year were as follows:

Mrs June Bend	Treasurer
Mr John Clayton	Pastor
Mrs Carole Clayton	Trustee
Mrs Shirley McEwen	Trustee
Mrs Lynn Wood	Trustee/Secretary
Mr Peter Collins	Chair - appointed 27/05/2020

Trustees are selected from within the congregation and those who have also expressed an interest in being involved in the running of the charity.

**3. Activities**

The Charity provides religious services, recreational and educational activities in the Morecambe and Lancaster area, and meets in Morecambe Bay Community Primary School.

A planned programme of services, learning and education activities is provided.

The trustees have had due regard to guidance published by the Charity Commission on public benefit.

**Continued.....**

## Gateway Church, Morecambe Report of the trustees

### 4 Summary of Main Achievements

This has been a year of the unseen and unknown a global pandemic of seismic magnitude. Were we ready to cope with all the implications it has brought to us? I'm afraid not! Like every other church and organisation we have had to quickly learn ways of managing and adjusting to keep things going in the best possible way. To be honest, this year has been our most challenging yet. First we lost our meeting place at the local school, and also access to all our equipment – which felt at the time to be a major loss. The only route available to us was to go online and the technology was totally unfamiliar to us. Eventually, through perseverance – and many mistakes, we were able to put our services online – and whilst they weren't as professional as some – at least in the beginning – we have progressed and learned along the way.

After the first lockdown was lifted we were offered the use of a room in Grace Ministries Morecambe (A Christian outreach centre) and this met our needs for a short time as it allowed groups of 12 people to meet legally under Covid restrictions. It was a real blessing to us as we were also able to record our meetings there so that those who were unable to attend could have a more rounded experience online. When the second lockdown came it was back to pre-recorded material for our online services. We contacted the school where we originally met and it became clear that we would be unable to resume our meetings there for some considerable time due to the stringent measures they had put in place to ensure safety. Thankfully we were offered the use of a room at our local Baptist Church and this has allowed us to meet safely whilst remaining compliant with Covid restrictions. We are presently still meeting there and will be able to do so whilst these restrictions remain in place. At least for the foreseeable future.

Throughout the past year we have tried to maintain as much support as practically possible to our congregation, though this has mainly been through phone calls and media interventions due to restrictions – with the odd visit when this has been allowed. Financial support has continued to be given to both individuals in need, and also to organisations we have supported in the past, here and abroad. (eg; CAP and ICEJ). A special gift has also been given to help pay towards medical treatment and expenses for our reserve missionaries wife.

One benefit of the past year has been a significant increase in our finances. This has been partly due to the reduction in rental fees (as we couldn't meet together) and also to an increase in giving. Earlier in the year we applied for a grant from the Norman Whitley Trust – for new equipment, and we were blessed to receive £3,000. This enabled us to invest in a video camera and stand and also a new Apple Mac computer, which has been a boon to aid our general online presentation. A new laptop has also been purchased for our treasurer to help with online banking and Administration work.

In conclusion, this has been a year of dramatic changes and we've had to adapt to these as they have arisen. We have learned how to better deal with the technology of online meetings and how to develop them more effectively. Despite the obvious traumas and difficulties we have encountered within each of our individual lives, both as a result of the pandemic – through financial hardships and health concerns, and also due to many deep losses, sadness and isolation during these unprecedented times, we have been blessed in many ways and are thankful to have such a supportive group of people around us.

We look forward to the future, believing that our God is sufficient for all our needs through his riches and glory. That he is always with us – and that, ultimately he is in control.

**GATEWAY CHURCH, MORECAMBE  
REPORT OF THE TRUSTEES (continued)**

**5. Policies**

**a) Risk Management**

The Trustees regularly review the major risks associated with the charity and have developed an action plan to minimise and effectively manage those risks.

**b) Reserves**

It is the intention of the Trustees that taking one year with another, the expenditure incurred will match the income generated through members' contributions, tithes and donations, with the benefit of Gift Aid where applicable.

However, the Trustees attempt to maintain a working bank balance of approximately £2,000 representing approximately one month's expenditure, in order to provide a buffer in the event of interrupted income.

**6. Financial Review**

Being a small Charity, the accounts have been prepared on the basis of amounts received and paid during the year. The Statement of Assets and Liabilities (on page 6) does however show the amounts owed to, and owing by the Charity at the end of the year.

The Trustees are satisfied with the financial results for the year, and has completed the year with monies in hand.

Signed on behalf of the Trustees

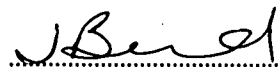
  
.....

Trustee

Date: 21-6-21

**Principal Office:**  
**12 Victoria Street**  
**Morecambe**  
**LA4 4AH**

**GATEWAY CHURCH, MORECAMBE  
RECEIPTS AND PAYMENTS ACCOUNT  
FOR THE YEAR ENDED 31 DECEMBER 2020**

	<u>Unrestricted</u> £	<u>Restricted</u> £	<u>Total</u> <u>2020</u> £	<u>Total</u> <u>2019</u> £
<b><u>INCOMING RESOURCES</u></b>				
<i>Income from charitable activities</i>				
Collections and members' tithes	28,128.57	-	28,128.57	19,319.00
Grants Received	3,000.00	-	3,000.00	-
Bank interest	0.18	-	0.18	-
	<u>31,128.75</u>	<u>-</u>	<u>31,128.75</u>	<u>19,319.00</u>
<b><u>RESOURCES EXPENDED</u></b>				
<i>Charitable expenditure</i>				
<b>Cost of Providing Services (Charitable Activities)</b>				
Staff wages	7,815.80	-	7,815.80	6,000.00
Premises rent, rates & water	3,549.68	-	3,549.68	9,026.00
Small items of equipment	507.34	-	507.34	-
Computer, software & internet expenses	121.75	-	121.75	190.00
Postage, stationery & advertising	20.00	-	20.00	51.00
Insurance	367.92	-	367.92	84.00
Donations & gifts	3,970.10	-	3,970.10	1,957.00
Subscriptions	108.80	-	108.80	158.00
Licences	98.67	-	98.67	-
Cleaning & sundries	90.00	-	90.00	215.00
Accommodation, meals and outings	426.51	-	426.51	80.00
Speakers	225.00	-	225.00	250.00
	<u>17,301.57</u>	<u>-</u>	<u>17,301.57</u>	<u>18,011.00</u>
<b>Governance Costs</b>				
Independent Examination & Accountancy	754.80	-	754.80	737.00
	<u>18,056.37</u>	<u>-</u>	<u>18,056.37</u>	<u>18,748.00</u>
<b><u>NET RECEIPTS FOR YEAR</u></b>	<u>13,072.38</u>	<u>-</u>	<u>13,072.38</u>	<u>571.00</u>
<b>Balances at the start of the year</b>	<u>1,144.00</u>	<u>-</u>	<u>1,144.00</u>	<u>573.00</u>
<b>Balances at the end of the year</b>	<u>14,216.38</u>	<u>-</u>	<u>14,216.38</u>	<u>1,144.00</u>
<b>Represented by:</b>				
Bank	14,117.49	-	14,117.49	1,120.00
Cash	98.89	-	98.89	24.00
	<u>14,216.38</u>	<u>-</u>	<u>14,216.38</u>	<u>1,144.00</u>

**GATEWAY CHURCH, MORECAMBE  
STATEMENT OF ASSETS AND LIABILITIES  
AS AT 31 DECEMBER 2020**

	<u>2020</u>	<u>2019</u>
	£	£
<b>Monetary Assets</b>		
Cash at Bank and in hand	14216.38	1,144.00
	<u>14216.38</u>	<u>1,144.00</u>
<b>Liabilities</b>		
Accruals:		
Accounting fees	618.00	606.00
	<u>618.00</u>	<u>606.00</u>

**Note:**

The above figures do not include Gift Aid recoverable on tithes from members for the period July to December as it had not been claimed at year end.

**Approved by the Trustees and signed on their behalf:**

*J. Bend*  
.....  
**Trustee**

21-6-21.  
.....  
**Date**



## Independent Examiner's Report to the Trustees of Gateway Church, Morecambe

I report to the charity trustees on my examination of the accounts of the charity for the year ended 31 December 2020 which are set out on pages 2 to 5.

### Responsibilities and basis of report

As the charity's trustees you are responsible for the preparation of the accounts in accordance with the requirements of the Charities Act 2011 ('the Act').

I report in respect of my examination of the charity's accounts carried out under section 145 of the Act and in carrying out my examination I have followed all the applicable Directions given by the Charity Commission under section 145(5)(b) of the Act.

### Independent examiner's statement

I have completed my examination. I confirm that no material matters have come to my attention in connection with the examination giving me cause to believe that in any material respect:

1. accounting records were not kept in respect of the charity as required by section 130 of the Act; or
2. the accounts do not accord with those records

I have no concerns and have come across no other matters in connection with the examination to which attention should be drawn in this report in order to enable a proper understanding of the accounts to be reached.

Signed

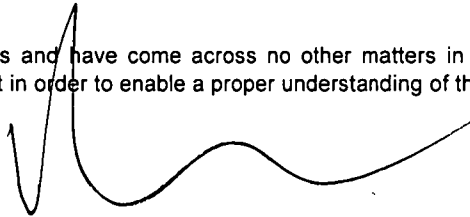

D Sissons

Chartered Accountant

Waters and Atkinson Chartered Accountants  
The Old Court House  
Clark Street  
Morecambe  
LA4 5HR

Date 29.6.21